

## Sideboards

### Contemporary Style (with finger grooves)



*Hampton*  
65½ w x 36 t x 18 d

### Shaker Style (with Shaker Inspiration knobs)



*Hampton*  
66½ w x 36 t x 19 d

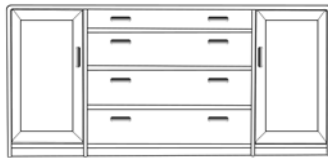

*Candi*  
65½ w x 30¾ t x 18 d



*Bradlee*  
53 w x 36 t x 19 d

*Contemporary*  
Hampton

\$ 3,255  
3,425  
3,770

*Contemporary*  
Candi

\$ 3,400  
3,575  
3,935

red oak or birch  
¼-sawn white oak, cherry or maple  
walnut, mahogany, white oak stained dark

*Shaker*  
Bradlee

\$ 2,625  
2,760  
3,040

*Shaker*  
Hampton

\$ 2,880  
3,030  
3,335

## Shaker Sideboards with Hutches

*Shaker Style*  
Hampton  
with  
hutch

\$ 5,105  
5,395  
5,960

Hutch measurements  
(if wall-mounted as shown)  
69 w x 31½ t x 15¾ d

Hutch measurements  
(if sideboard-mounted as shown)  
54½ w x 47½ t x 17¾ d

*Shaker Style*  
Bradlee  
with  
hutch

\$ 4,650  
4,905  
5,430

red oak or birch  
¼-sawn white oak, cherry or maple  
walnut, mahogany, white oak stained dark

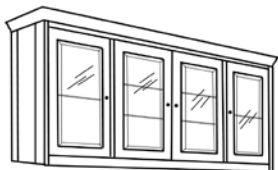

*Both methods of mounting the hutch are available for both the Shaker pieces; the method of mounting does not change the price. We install wall-mounted hutches if the customer has chosen for us to deliver the furniture.*

*Shaker hutches are built with beveled glass-panel doors, glass shelves, crown molding and Shaker Inspiration knobs.*

*Shaker cabinets include solid tops, pedestals, drawers and shaker-style doors; veneer sides and adjustable wood shelves; silverware holders and Shaker Inspiration knobs.*

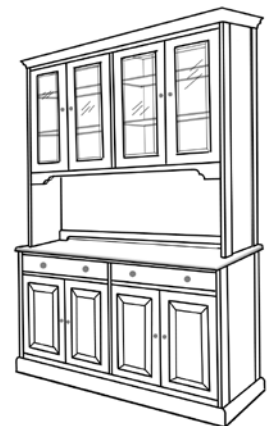
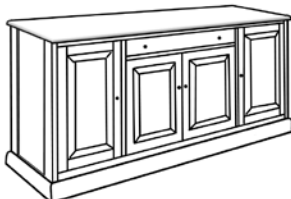

*Hutch options: (2) canister lights (Bradlee)—add \$95. (4) canister lights (Hampton)—add \$190  
Solid tongue and groove plank back—add \$455.*